

GOMUN

5. - 8.11.2021

H
A
N
D
B
O
O
K



Prague, Czech republic



CONTENT

01 What is GOMUN?

02 Meet the organisation team

03 Venues

04 Events

05 Social Event

06 Agenda

07 Committees

08 Scheme of Gymnázium Omská

09 Prague: Historical sights

10 Prague: Cultural sights

11 Prague: Places you can't miss I

12 Prague: Places you can't miss II

13 Prague: Transportation, Exchanging and Withdrawing Money

14 Thank you



WHAT IS GOMUN?

Model United Nations (abbrev. MUN) is an educational event invented for high-school students from all over the world. The concept simulates a UN conference during which students (delegates of UN countries) separate into various committees and discuss today's greatest issues. During a two-day debate the delegates are supposed to come up with a solution suitable for the majority of countries represented at the conference. These solutions are then discussed at the General Assembly, the great finish that all MUN conferences lead to. The debate is moderated by realistic Rules of Procedure which the participants have to comply with.



Gymnázium Omská Model United Nations is a Prague based MUN, named after the organising school. GOMUN also provides, besides the traditional awards, the Best Newcomer award for the most distinguished MUN first-timers in each committee.



MEET THE ORGANISATION TEAM



Anna Kedlická

Main Organiser, Head of PR and HR



Rozárie Haškovcová

Secretary - General



Marek Řezníček

Head of Finance



Anna Bachová

Venues Manager



Klára Němcová

Head of Registration



Ester Hrdinová

Staff Recruiter



Kateřina Tranová

Social Events Manager



Kateřina Dlouhá

Head of Communication



Veronika Laušmanová

Social Networks Manager



Gymnázium Omská

The beloved grammar school of „Omská“ is the main venue of the conference. This school defines GOMUN by its name but even all the passion that stands behind all of it. Committee sessions will take place here and so this will be the place to go on Saturday and Sunday. The closest public transport stops are „Kubánské náměstí“ (tram stop of lines 6, 7, 22 and 19) or „Murmanská“ (bus stop of line 175)



**Omská 1300/4, 100 00,
Vršovice, Praha 10**

Prague City Hall

Being the most honourable venue of all, the conference hall of the Prague New Municipality will host the Opening and Closing Ceremonies as well as the General Assembly. Therefore, the conference programme will take place at this venue on Friday and on Monday.

The closest public transport stop is the underground station of metro line A (green) – „Staroměstská“. The city hall is located right next to the Old Town Square.



**Mariánské náměstí 2, 110 00,
Josefov, Praha 1**



Masaryk Dormitory of CTUP

Masaryk Dormitory of the Czech University of Technology in Prague will be the venue for this year's GOMUN own social event – the ball. Here, you can look forward to having an amazing Sunday evening. Using public transport, this venue is best accessible from a tram and bus stop „Thákurova“ (more than 15 lines) or from an underground station „Dejvická“ (metro line A – green).



**Thákurova 1, 160 41
Dejvice, Praha 6**



EVENTS

OPENING CEREMONY

During the Opening Ceremony the delegates are welcomed by several speeches usually delivered by the organisers and guest speakers. An introductory debate also takes place to warm the delegates up before the committee work starts.



 PRAGUE CITY HALL

ICEBREAKERS

Icebreakers are the most informal event of MUN conferences. Many various games are played separately in each committee to set the atmosphere and to get to know each delegate (and the chairs) better.



 GYMNÁZIUM OMSKÁ

COMMITTEE WORK

Committee Work stands for the most important part of the conference in forming the resolution. The delegates try to come up with the best solutions of the committee's topic by sharing their opinions and ideas in heated debates.



 GYMNÁZIUM OMSKÁ

SOCIAL EVENT

The official social event of GOMUN is the Sunday GOMUN Ball. The delegates may enjoy music, dancing battles or funny competitions between each other in an opulent hall in the Masaryk Dormitory.



 MASARYK DORMITORY OF CTUP

CLOSING CEREMONY

The conference is summarized and reviewed during Closing Ceremony. The organisers give their thanks to all the participants and sponsors. Finally, the organisers declare the conference closed.



 PRAGUE CITY HALL

S O C I A L E V E N T

WHAT CAN YOU EXPECT?

The event takes place on Sunday at 7:30 pm in the great hall of Masarykova Kolej. The whole evening will be accompanied by music. All guests are going to have seats reserved at their tables in the hall nonetheless all present are invited to take part in the classical, Latin and modern dances. In the first half of the evening one can expect dances like waltz, waltzer, blues, cha-cha, tango or jive, in the second half we will play modern dance music. For the duration of the event small refreshments and water will be offered to any and all guests, furthermore a bar where one can purchase sweet and alcoholic drinks will be available (please be aware, that the law forbids everyone under the age of eighteen from drinking alcoholic beverages).

PROGRAMME

The event begins at 7:30 pm exactly, though guests are welcomed to arrive in advance and get comfortable. After the official opening of the evening, the program will continue with two thirty-minute blocks of classical and Latin dances and the choice of king and queen of the Ball. Three modern and disco dance blocks with short brakes will follow right afterwards. During the whole event, all participants can order a song of their choice. The whole evening will come to a close with the official ending of the event at 11:30 pm.

DRESS CODE

Please do note, that guests are expected to adhere to the formal dress-code. For men, the outfit can stay the same as during the committee sessions, though switching a tie to a bowtie would be appreciated, women, however, are recommended to wear a night dress or a robe.

TRANSPORTATION

The best way to get to the Venue is by the underground A (green) line, you can get on the A-line at any of its seventeen stations, though if you stay at a hotel near the main conference venue, consider either the Strašnická or Náměstí míru station. The Venue is about four minutes of walk from the A-line station Dejvická, where you should exit the underground. On your way back, please remember that the last underground train runs at 0:10. In the case, that you want to leave at a later time, we suggest, either using Uber, or taking the night tram n. 91, which stops right in front of the Venue, to station Lazarská, then switching to line n. 99.

AGENDA

FROM	TO	PLACE	EVENT	NOTE
FRIDAY 5th November				
8:30	10:00	PRAGUE CITY HALL	REGISTRATION	Refreshment available.
10:00	13:00	PRAGUE CITY HALL	OPENING CEREMONY	Includes guest speakers', organisers' and SC P5 speeches and a coffee break.
13:00	13:45	PRAGUE CITY HALL	LUNCH	Followed by transport to Gymnázium Omská.
15:30	17:30	GYMNÁZIUM OMSKÁ	ICEBREAKERS	Separately in committees; refreshment available.
SATURDAY 6th November				
8:30	9:00	GYMNÁZIUM OMSKÁ	REGISTRATION	Refreshment available.
9:00	12:30 13:00	GYMNÁZIUM OMSKÁ	COMMITTEE WORK	Includes coffee breaks.
12:30 13:00	13:00 13:30	GYMNÁZIUM OMSKÁ	LUNCH	Committees separately to prevent overcrowding – time may differ.
13:00 13:30	17:00	GYMNÁZIUM OMSKÁ	COMMITTEE WORK	Includes coffee breaks.
SUNDAY 7th November				
8:30	9:00	GYMNÁZIUM OMSKÁ	REGISTRATION	Refreshment available.
9:00	12:30 13:00	GYMNÁZIUM OMSKÁ	COMMITTEE WORK	Includes coffee breaks.
12:30 13:00	13:00 13:30	GYMNÁZIUM OMSKÁ	LUNCH	Committees separately to prevent overcrowding – time may differ.
13:00 13:30	17:00	GYMNÁZIUM OMSKÁ	COMMITTEE WORK	Includes coffee breaks.
19:30	23:30	CTUP DORMITORY	SOCIAL EVENT	Authentic formal ball of GOMUN.
MONDAY 8th November				
9:00	9:30	PRAGUE CITY HALL	REGISTRATION	Refreshment available.
9:30	13:00	PRAGUE CITY HALL	GENERAL ASSEMBLY	Includes coffee breaks.
13:00	13:45	PRAGUE CITY HALL	LUNCH	
13:45	17:00	PRAGUE CITY HALL	GENERAL ASSEMBLY	Includes coffee breaks.
17:00	18:00	PRAGUE CITY HALL	CLOSING CEREMONY	Organisers' speeches, conclusion of the conference, best delegates, chairs

On this page, you can find the approximate schedule for the conference. Look for details of the events and venues in this handbook, our website or ask the organisers! Keep in mind that this agenda has only indicative purposes. Times and events may differ slightly, according to current situation. Rights for changes are reserved.

COMMITTEES

SC

**Topic: Bringing an end to the conflict
Syria and resolving the Turkish
occupation of Northeastern Syria**

Classroom no. 15
Chairs: Ondřej Klásek and Šimon Buranský



HSC

Topic: Suez Crisis

Classroom no. 16
Chairs: Filip Choděra and Marek Řezníček



SPECPOL

**Topic: The issue of breaches of the
Antarctic treaty system
and
The reignited conflict in Palestine**

Classroom no. 9
Chairs: Anna Bachová and Lucie Fornůsková



Rules of
procedure are
available here



HRC

**Topic: The issue of slave and unfair
labour especially in the fast fashion
industry
and
The ongoing issue of interracial hate,
misunderstanding and inequality**

Classroom no. 11
Chairs: Zuzana Augustová and Denis Borek



SCES

**Topic: Solving the critical
implications of excessive emissions
originating from world's most
polluting states or state unions**

Classroom no. 10
Chairs: Martin Dlouhý
and
Veronika Laušmanová



SCHEME OF GYMNÁZIUM OMSKÁ



Below, you can find a simplified map of the main venue, Gymnázium Omská, where the committee work takes place. In case you get lost or confused, feel free to ask any of the admins or organisers!

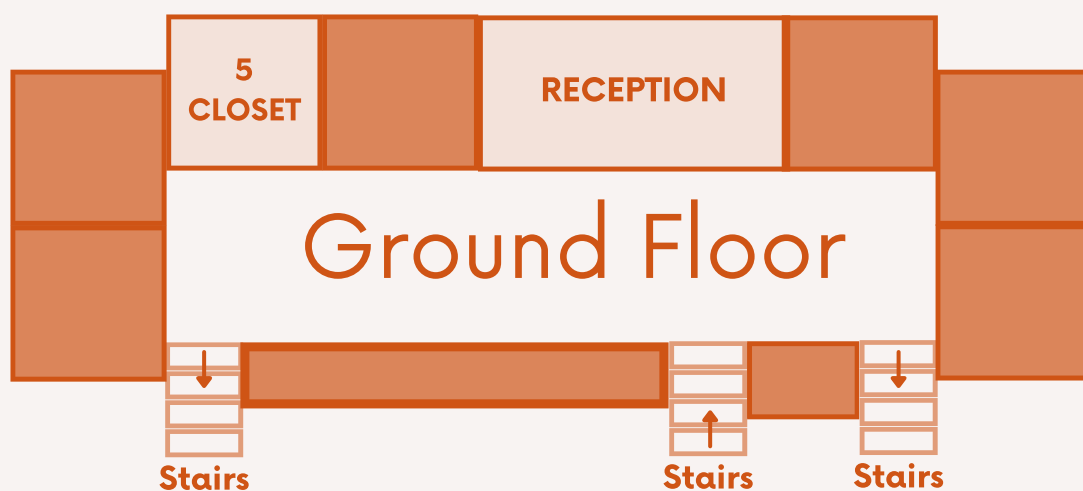

PRAGUE: Historical sights



Prague Castle

A sight that you definitely shouldn't miss when visiting Prague. Prague Castle is the largest coherent castle complex in the world and the St. Vitus Cathedral at the courtyard is a true architectural masterpiece. It is also interesting for its variety of architectural styles as almost every ruler who reigned from there added something from his era (the pronoun "his" is really correct, there had been not a single woman ruler reigning from Prague Castle in the whole Bohemian history).



Wenceslas Square and Old-Town Square

Wenceslas Square and Old-Town Square are the two main squares in Prague while being only 5 minutes away from each other by foot. At the top of Wenceslas Square are the monumental National Museum and the statue of St. Wenceslas on his horse in front of the Museum. Old-Town Square with its ancient buildings, magnificent churches, and the Astronomical Clock, is one of the most beautiful European sights.

Charles Bridge

Charles bridge is the most famous bridge in Prague. It was built by an important Czech king - Charles IV. after whom it is named. The bridge is embellished with statues of saints and the Holy Crucifix. Hundreds of tourists cross this bridge every day because it connects two parts of the city centre (Prague Castle and Old-Town Square) and because of its beauty.



PRAGUE: Cultural sights



Střecha Lucerny

One of the best places, from which you can see all over the beautiful city of Prague. This so-called roof or terrace is yet another place in Prague, which is worth visiting with friends. If you wish to have a nice relaxing time together, looking at the gorgeous scenery our city offers.



Františkánská zahrada

If you wish to visit some nature, but fancy something more elegant than a simple park, these gardens might be a good choice. It is a place near the Wenceslas square, where you can sit on one of the many white benches, surrounded by roses and flowers of many kinds, and enjoy the calming yet very lively atmosphere.

Grébovka and Stromovka

Another parks worth visiting are Grébovka and Stromovka. If you are looking for a cozy area with some fresh air, we would definitely recommend one of these two parks, which are great for picnics, sports, or relaxing walks. In addition to that, Grébovka is only 10 minutes away from Gymnázium Omská and you can get there easily by tram.



Petřín Tower

The Petřín Lookout Tower is a 63 metres high steel tower in Prague. It was built in 1891 and it's inspired by the Eiffel Tower. Petřín tower is a major tourist attraction because the view from its top overlooks the whole city. You can also have a walk in a park surrounding the tower.

P R A G U E: Places you can't miss I

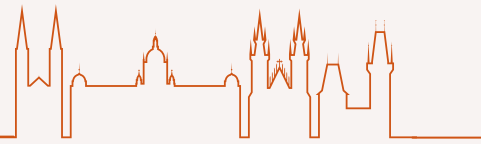

Výtopna Railway Restaurant

The Railway Restaurant, which can be found in Prague's centre, is a simply splendid place where you can enjoy both tasty food and a very extraordinary experience of little trains delivering your dish right in front of you. This place is great for friend groups who would like to have a nice meal together but at the same time have lots of fun.



Vinohradský parlament

Vinohradský parlament is yet another great restaurant, where you can enjoy a nice lunch with friends. What is special about this establishment, which can be found in the city centre, is their traditional Czech dumplings and also their beer.

James Dean

If you are a fan of the American 50s, we would like to recommend the James Dean diner, which is in the very centre of Prague. You can enjoy a classic American meal while listening to your favorite retro songs.



DID YOU KNOW?

Prague has been voted the most beautiful city in the world.
The City of a Hundred Spires beat New York, Paris and Chicago to the top spot

P R A G U E: Places you can't miss II



Tvoje máma

Tvoje máma is a very lovely café, only 3 tram stops from our school. If you are looking for a place with a calm and comfortable atmosphere where you can study, chat with friends or just simply relax, this café is perfect for you.



Letterpress Cafe

A cup of exclusive coffee, cozy and peaceful surroundings, sweet personnel. You can order a nice cup of your favorite coffee, but that is not all there is to this beautiful place. If you are lucky enough, you can get to see the printing in progress and try it on your own. The café also offers a 20% discount if you prove that you are a GOMUN participant. Needless to say, this place is definitely worth visiting



GOMUN SUPPORTS SUSTAINABILITY

On this note, we would love to invite you to some of the best thrift shops here in Prague. If you'd like to buy pretty, unique and sustainable clothes, we recommend visiting some of the stores listed above.

1981

The first place we would love to recommend is the 1981 Secondhand. If you are looking for stylish and vintage clothes, Secondhand 1981 is just the place for you!



Moment

This unique thrift shop contributes money to non-profit making organizations, so by shopping there, you can help more than only one cause.

Filtr Coffee and Clothes

An amazing combination of a thrift shop and brew bar, where you can find authentic clothing and while doing so, you can also enjoy a perfect cup of your favorite coffee.



PRAGUE:

Transport, Exchanging and Withdrawing Money



Prague public transport system is regarded as one of the best in the world, its price/performance ratio unmatched by any in Europe. Despite all of the praise it may be a bit confusing to navigate, we would like to, therefore, introduce you to its basics. The system consists of three lines of metro, trams, buses, couple ferries and a funicular and operates in two modes.

During the day (from 5:00 am - 12:00 pm) is the metro the backbone of the whole infrastructure, during the night (from roughly 00:20 am - 4:40 am) the backbone of the system are night trams (numbered 91 - 99). If you don't know how to get from one place to another we recommend using either google maps or PIDs (Prague public transport) own navigation system which you can find on www.pid.cz, there you can also find any additional information you may need.



To use the public transport, one needs to buy a ticket, those can be purchased in newsstands near stations, vending machines in the metro stations or special shops in metro stations run by PID. With tickets as a tourist, you have four options, the 30 min. ticket for 30 CZK, the 90 min ticket for 40 CZK, the 24-hour ticket for 120 CZK and 72- hour ticket for 330 CZK. Before their use all tickets need to be validated, this is done in validation machines, placed in trams and buses, in the case of underground, the validation machines are not placed in the train, but in the station, always before the escalators. The ticket must be inserted into validation machines in the direction of the arrow painted on the ticket. The time for which the ticket can be used counts from its validation, not its purchase. With one ticket you can use any and all transport vehicle types as many times as you like (buses, trams, underground, even the trains). Validate your ticket only once, tickets validated multiple times are considered invalid.



As you may have noticed, the Czech Republic doesn't use Euro, rather its own currency the Czech Crown. You can either exchange Euros for Crowns or you can withdraw some Crowns, but both can be quite tricky. It is quite common for exchange offices, to use highly unfavourable rates, or charge large fees. If you are dissatisfied with the rate, within three hours, provided you kept your receipt of your exchange,

you can demand your money back from the particular office (the exchanged money will be reverted with at the same rate). Even though the law requires this, you will usually have to be quite assertive and unyielding to get your money back. We also recommend avoiding withdrawing from Euronet ATM (marked with blue ATM writing on a yellow background) due to unfavourable rates.





We sincerely hope that you, the delegates, chairs, supervisors and representatives of our sponsors and partners, will enjoy the conference and will only leave on Monday evening with the best memories and experiences. We also wish you to find many new relations and friends, feel at home in our beautiful city of Prague and have a great time. Best of luck during the debates and don't be afraid to speak out, only good things can come out of it!

THANK YOU.





This is the end of the handbook.

by Anna Kedlická and the PR team

G O M U N 2 0 2 0

November, Prague

#GOMUN
@gomunconference
www.gomun.cz
info@gomun.cz